

PLANTA DE FUNDACION

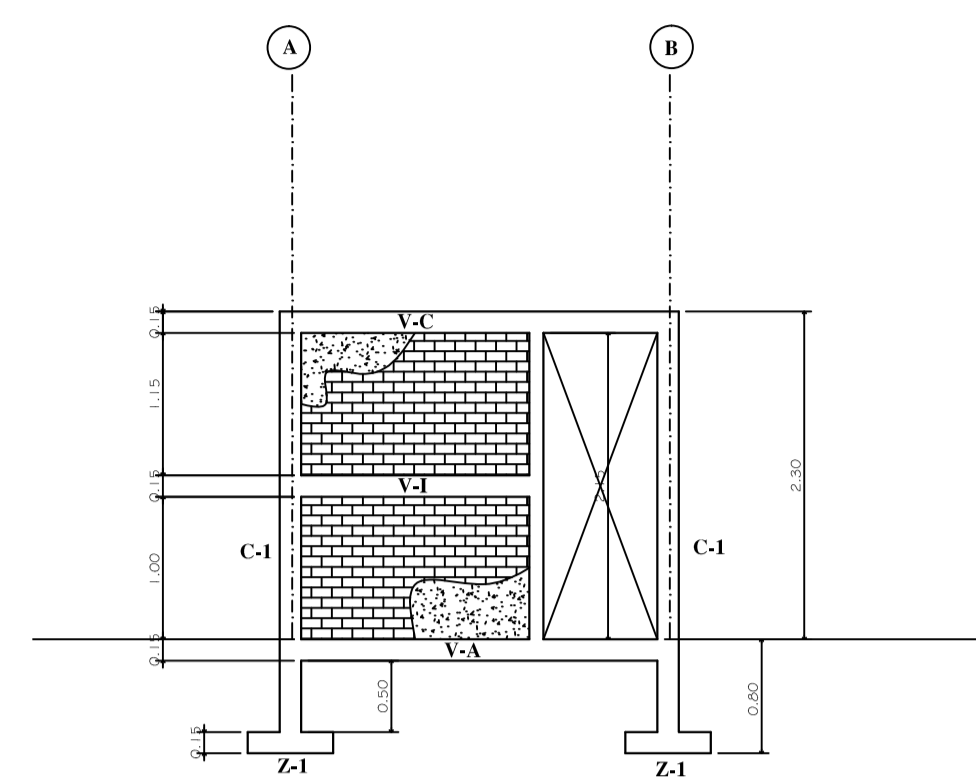

ELEVACION ESTRUCTURAL EJE 1

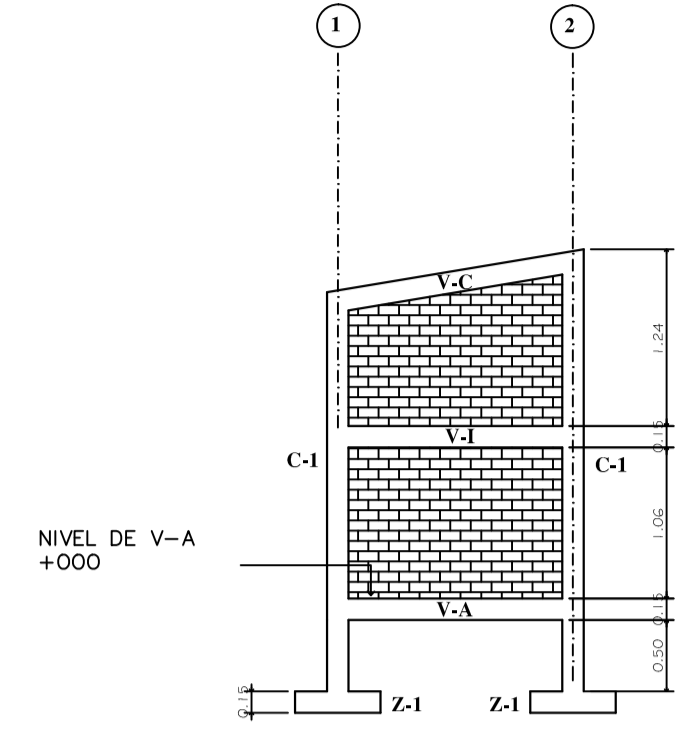

ELEVACION ESTRUCTURAL EJE B

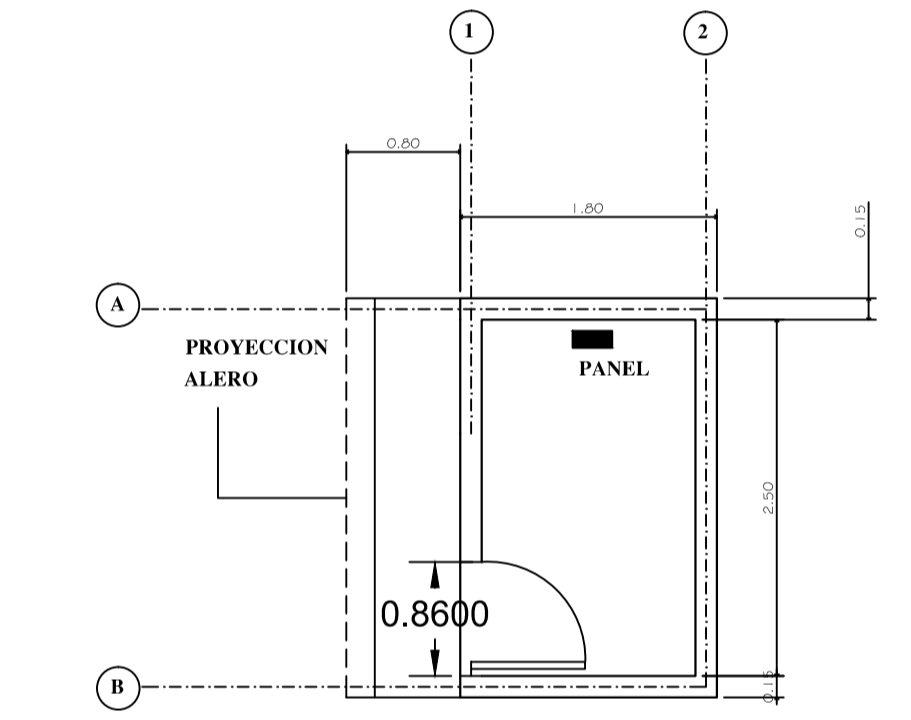

PLANTA ARQUITECTONICA CASETA DE CONTROL

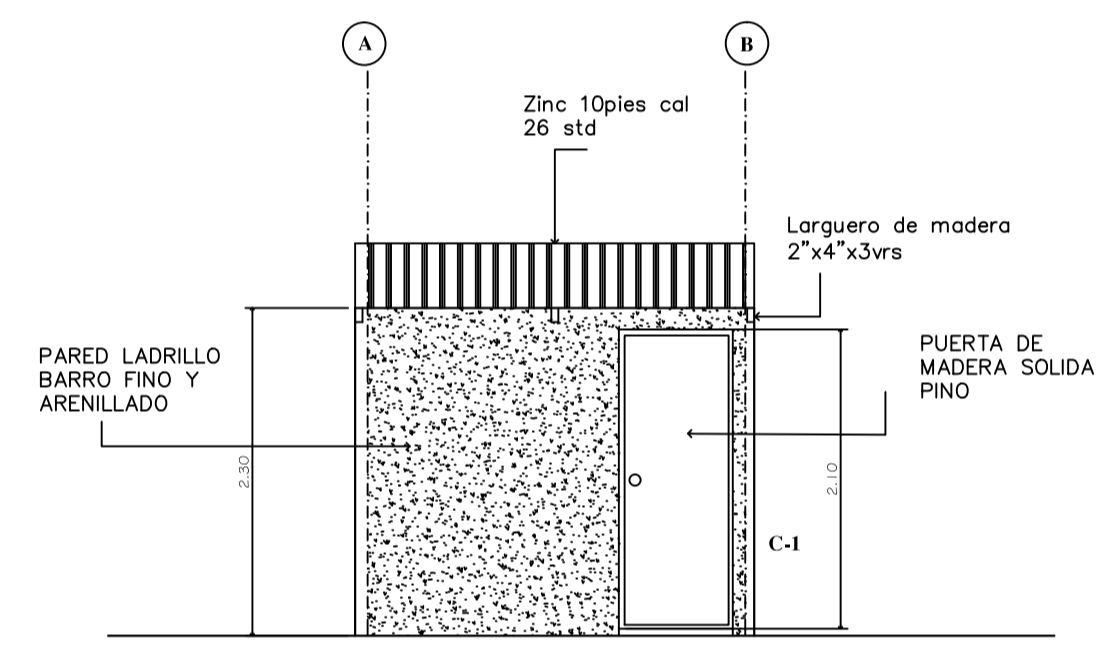

ELEVACION CASETA DE CONTROL EJE 1

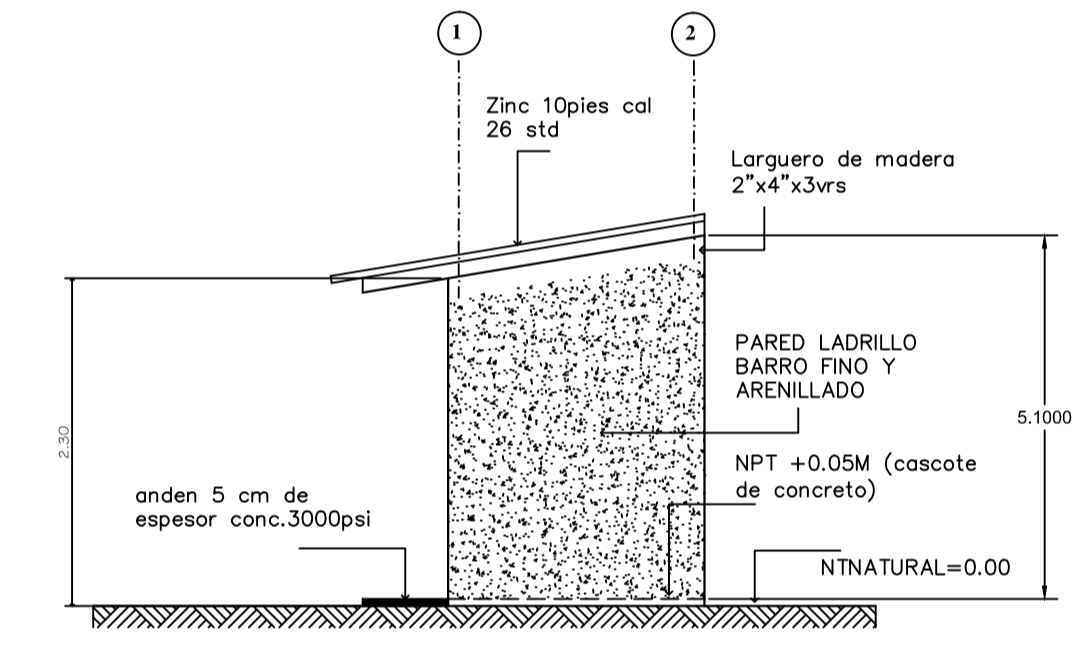

ELEVACION CASETA DE CONTROL EJE B

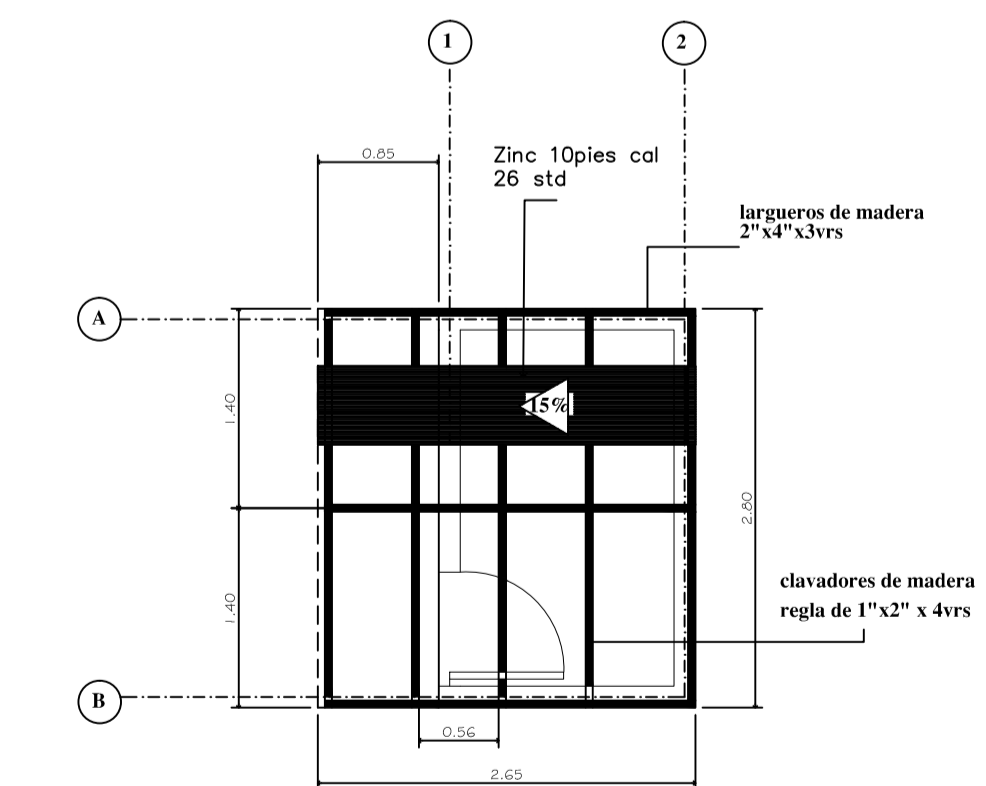

planta estructural de techo

CASETA DE BOMBEO

esc-1/50

DETALLES

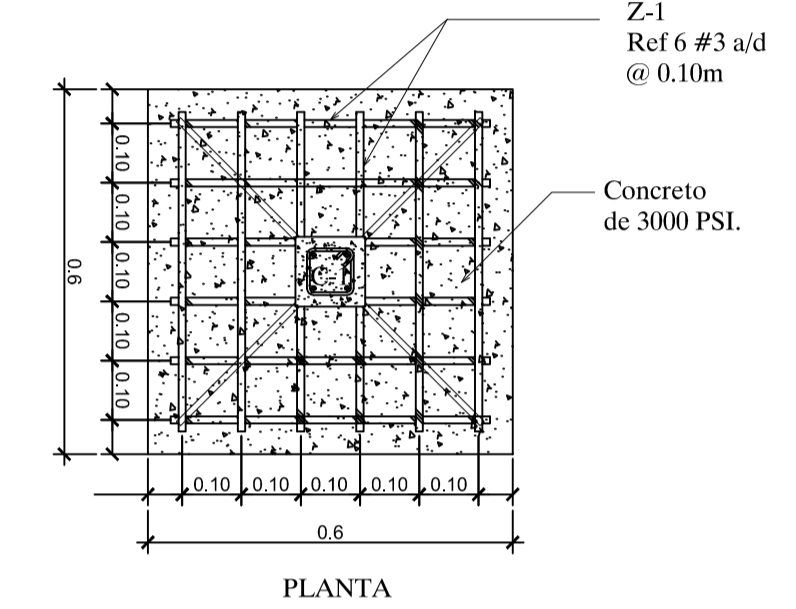
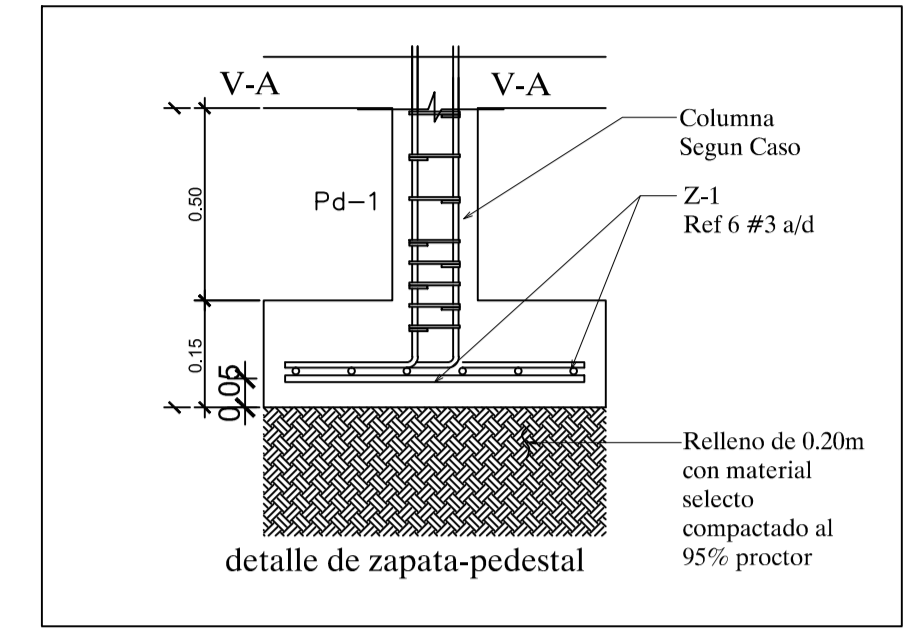

DETALLE DE ZAPATA Z-1

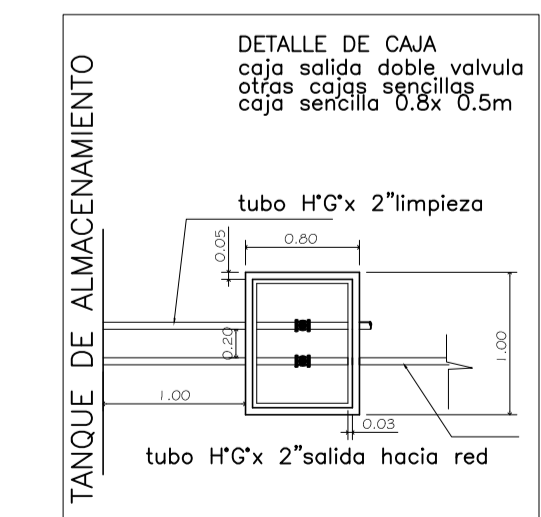
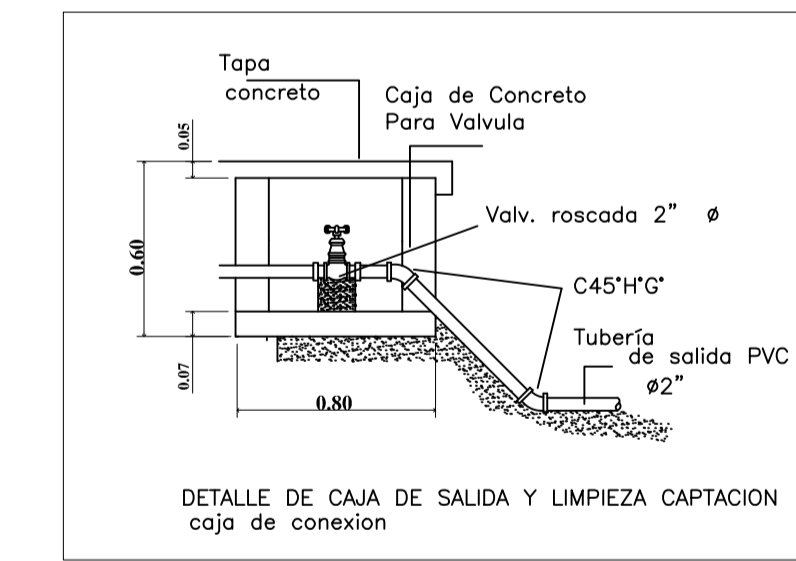
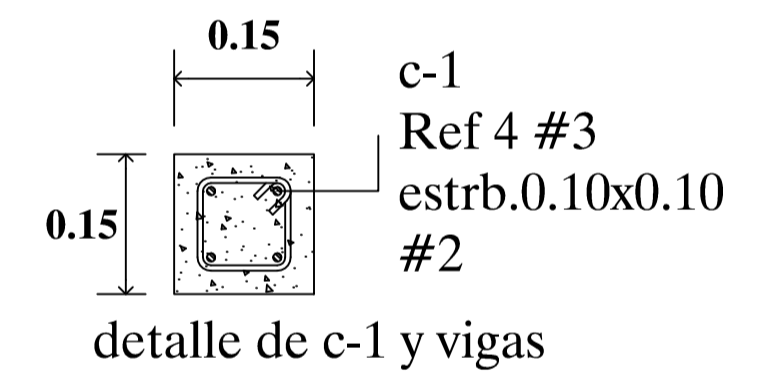

LAMINA #3	L-3	L-3
	L-3	
COORDINADOR: ING. SANTIAGO BETANCO	CONTENIDO: BOMBEO	ING. SANTIAGO BETANCO
DESIGNO: ING. ARQ. SANTIAGO BETANCO	ESCALA: INDICADA	ING. SANTIAGO BETANCO
TOPOGRAFIA: ASIDCON	FECHA: ABRIL-2019	ING. SANTIAGO BETANCO

**PROYECTO AGUA Y SANEAMIENTO
EN MABE COMUNIDAD EL BRAMADERO
MUNICIPIO DE CONDEGA , ESTELI**